

# 3000 SERIES CONTROL DAMPER JUMPER INSTALLATION

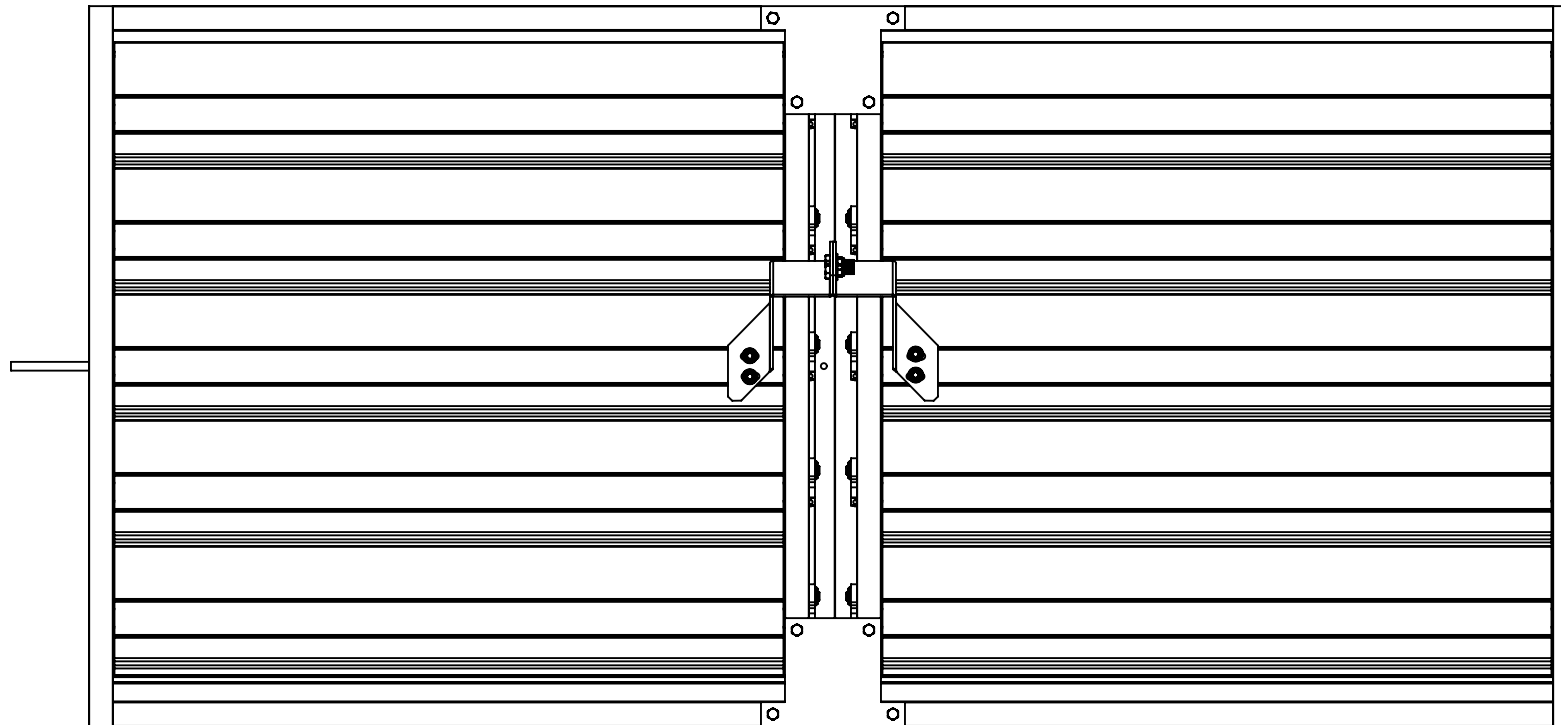

1. U-BOLT
2. WASHER
3. HEX NUT
4. HEX CAP SCREW
5. JUMPER (LEFT SIDE)
6. JUMPER (RIGHT SIDE)

**STEP 1:** REMOVE EXISTING HEX NUTS AND WASHERS FROM U-BOLTS ON DRIVE BLADES. *DO NOT REMOVE U-BOLT.*

**STEP 2:** ATTACH JUMPERS TO U-BOLTS (ON DRIVE BLADES) AND FASTEN WITH HEX NUTS AND WASHERS THAT WERE REMOVED FROM STEP 1.

**STEP 3:** FASTEN JUMPERS (LEFT AND RIGHT SIDE) TOGETHER WITH HEX CAP SCREWS, WASHERS, AND HEX NUTS AS SHOWN.

**STEP 4:** CYCLE THE DAMPER MANUALLY TO ENSURE SMOOTH OPERATION.

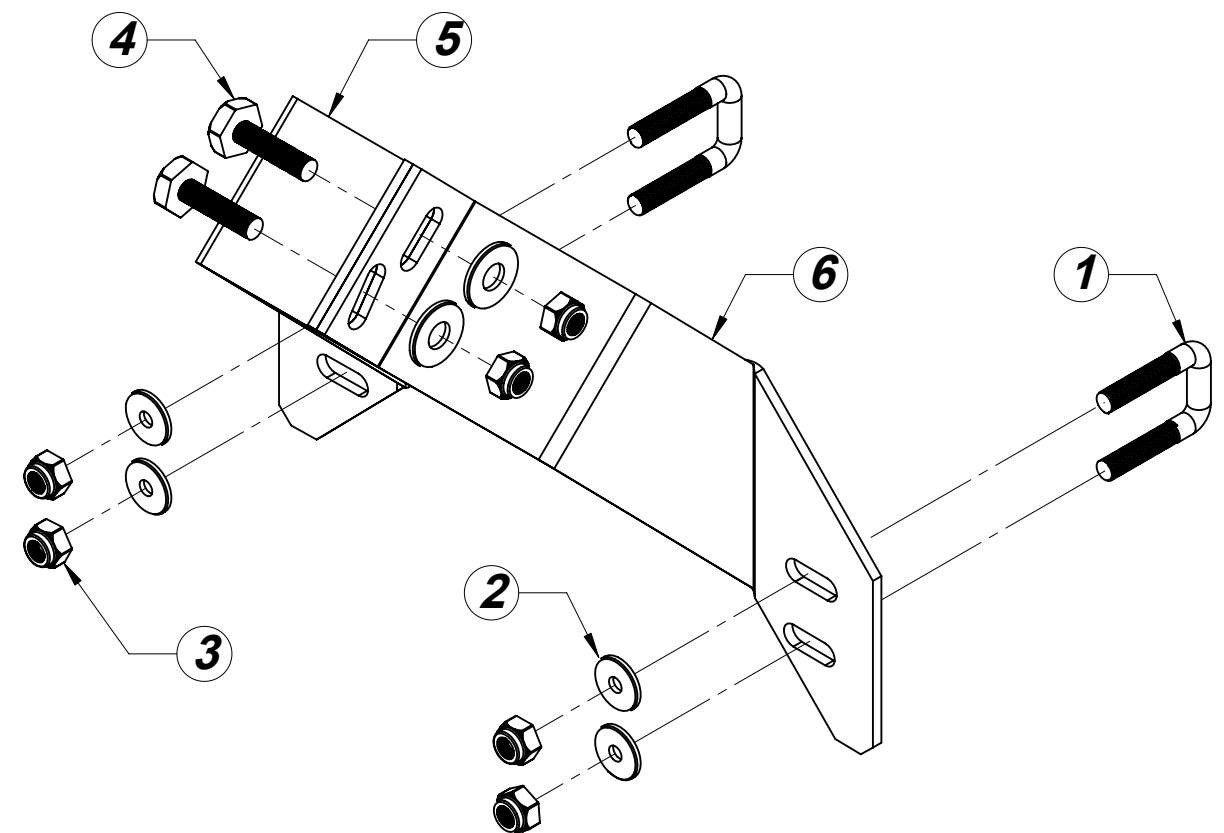

195 HEALEY ROAD  
BOLTON, ON. L7E 5B2  
TEL: 905-857-4700  
FAX: 905-857-4730  
TOLL FREE: 1-800-668-7214  
[www.ventexinc.com](http://www.ventexinc.com)

**ARCHITECT/CUSTOMER NOTE:**  
IT IS THE RESPONSIBILITY OF THE  
ENGINEER OF RECORD TO ENSURE  
THAT THE WALL OR OTHER  
CONNECTION POINTS WILL  
WITHSTAND THE IMPOSED LOADS

## 3000 SERIES CONTROL DAMPER JUMPER INSTALLATION